

Type K

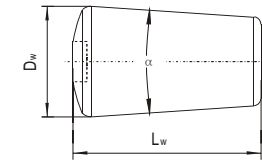

Type K

LYC Tapered Rollers

No.	Designations	Dimensions			Mass	Bearing No. for Reference
		D <sub>w</sub>	L <sub>w</sub>	R		
		mm			kg	
197	9.087×18.06×3°	9.087	18.06	3°	0.00818	
198	9.1×19.92×6°	9.1	19.92	6°	0.00790	32306AN
199	9.232×18.06×3°30'	9.232	18.06	3°30'	0.00845	
200	9.3×9.301×14°50'	9.3	9.301	14°50'	0.00375	LY-9004
201	9.367×15.8×5°30'	9.367	15.8	5°30'	0.00710	30306X2B/YB2
202	9.59×16.107×5°4'	9.59	16.107	5°4'	0.00800	
203	10×13.5×8°	10	13.5	8°	0.00650	
204	10.336×13.81×8°40'	10.336	13.81	8°40'	0.00725	31306/YB2
205	10.422×18.62×5°21'	10.422	18.62	5°21'	0.01040	M802048
206	10.601×22.26×3°16'	10.601	22.26	3°16'	0.01350	
207	10.634×20.94×6°	10.634	20.94	6°	0.01170	323/32
208	10.737×14.27×3°7'30"	10.737	14.27	3°7'30"	0.00930	37431A
209	10.77×22.273×3°5'	10.77	22.273	3°5'	0.01400	
210	11.35×20.65×6°	11.35	20.65	6°	0.01330	32307CN
211	11.4×21.83×3°10'	11.4	21.83	3°10'	0.01550	
212	11.92×15.63×5°	11.92	15.63	5°	0.01200	30211X2
213	12.35×25.8×3°50'	12.35	25.8	3°50'	0.02080	33910/YB2
214	12.4×22.08×2°50'	12.4	22.08	2°50'	0.01900	30616/YB2
215	12.5×29.05×1°40'	12.5	29.05	1°40'	0.02590	
216	12.7×22.87×6°	12.7	22.87	6°	0.01850	32308CN
217	13.2×29.56×2°	13.2	29.56	2°	0.02910	33019/YB2
218	13.3×22.97×2°30'	13.3	22.97	2°30'	0.02300	33114X2
219	13.752×25.5×3°10'	13.752	25.5	3°10'	0.02660	594A
220	13.8×33.9×3°30'	13.8	33.9	3°30'	0.03400	306/47
221	13.9×33.1×3°20'	13.9	33.1	3°20'	0.03390	DUF65168110
222	14.5×28.11×3°20'	14.5	28.11	3°20'	0.03220	DUF55168100
223	15.15×20.365×8°	15.15	20.365	8°	0.02300	30309X2B
224	15.47×30.27×2°10'	15.47	30.27	2°10'	0.04110	352026X2
225	15.64×30.18×1°50'	15.64	30.18	1°50'	0.04240	352936X2
226	15.76×33.11×3°14'	15.76	33.11	3°14'	0.04450	33118TN1
227	16×21.6×1°30'	16	21.6	1°30'	0.03270	D1007856
228	16.6×35.745×1°50'	16.6	35.745	1°50'	0.05620	352940X2
229	16.93×33.23×3°26'	16.93	33.23	3°26'	0.05160	LY-3026
230	17.081×31.76×3°	17.081	31.76	3°	0.05130	
231	17.58×29.08×2°	17.58	29.08	2°	0.05180	352936X2/YA4
232	17.8×36.15×3°50'	17.8	36.15	3°50'	0.06080	
233	18.278×34.13×3°10'	18.278	34.13	3°10'	0.06270	NA759
234	18.49×38.05×2°	18.49	38.05	2°	0.07400	352940X2/YA1
235	19.093×36.09×2°4'	19.093	36.09	2°4'	0.07500	352944X2
236	19.43×32.045×1°31'	19.43	32.045	1°31'	0.07080	32948/YB2
237	19.447×28.08×1°46'	19.447	28.08	1°46'	0.06180	37941K
238	19.6×42.13×3°	19.6	42.13	3°	0.08820	350620D1
239	20×35.054×2°10'	20	35.054	2°10'	0.08020	352948X2
240	20×35.1×2°	20	35.1	2°	0.07900	
241	20.8×26.56×8°	20.8	26.56	8°	0.05790	30313X2B
242	21.6×44.12×3°46'	21.6	44.12	3°46'	0.11000	33220/YB2
243	22×32.11×2°20'	22	32.11	2°20'	0.08940	M541349
244	22.8×38.76×3°	22.8	38.76	3°	0.11300	
245	23×21.775×7°52'	23	21.775	7°52'	0.06150	LY-9003

No.	Designations	Dimensions			Mass	Bearing No. for Reference
		D <sub>w</sub>	L <sub>w</sub>	R		
		mm			kg	
246	23.24×27.535×1°3'	23.24	27.535	1°3'	0.09220	LY-3019
247	24.3×28.456×3°30'	24.3	28.456	3°30'	0.09500	32006X2
248	24.755×31.339×8°	24.755	31.339	8°	0.09740	
249	24.805×38.106×3°	24.805	38.106	3°	0.13200	LY-3023
250	24.914×45.11×3°10'30"	24.914	45.11	3°10'30"	0.15500	
251	25×43.48×2°	25	43.48	2°	0.15600	32952X2
252	25×43.17×1°30'	25	43.17	1°30'	0.15900	352956X2
253	25.361×50.06×1°50'4"	25.361	50.06	1°50'4"	0.18500	M249749
254	25.381×50.057×1°50'4"	25.381	50.057	1°50'4"	0.18500	47T513627
255	25.505×46.078×2°16'	25.505	46.078	2°16'	0.17000	37248WF
256	25.772×48.774×1°35'	25.772	48.774	1°35'	0.18800	M257204
257	26×52.575×2°	26	52.575	2°	0.20200	352048X2
258	26.05×47.084×2°30'	26.05	47.084	2°30'	0.18000	352132X2
259	26.4×33.164×3°40'	26.4	33.164	3°40'	0.13000	LY-3029
260	26.46×48.085×2°	26.46	48.085	2°	0.19300	EE135111D
261	27.1×51.07×1°50'	27.1	51.07	1°50'	0.21600	M252304
262	27.54×38.277×2°	27.54	38.277	2°	0.17000	250KVE3601AEg
263	27.58×42.116×2°40'	27.58	42.116	2°40'	0.18200	350641D
264	28×50.568×1°30'	28	50.568	1°30'	0.23100	382968/HC C9
265	28.8×31.51×2°30'	28.8	31.51	2°30'	0.16300	382952X3
266	30×36.369×8°10'	30	36.369	8°10'	0.16600	45T202211-F2
267	30.18×46.386×1°46'	30.18	46.386	1°46'	0.24600	EE330116D
268	30.679×47.7×2°24'	30.679	47.7	2°24'	0.25700	47T563927AwH
269	31.1×53.358×2°30'	31.1	53.358	2°30'	0.29000	382044/HCYB2
270	32.026×41.129×2°30'	32.026	41.129	2°30'	0.24300	382052X2
271	33.6×59.55×2°	33.6	59.55	2°	0.37000	352052X2
272	35.719×60.173×3°10'	35.719	60.173	3°10'	0.42700	EE420804
273	38.4×84.62×2°30'	38.4	84.62	2°30'	0.69200	46T504125GWH
274	38.52×51.15×3°	38.52	51.15	3°	0.43200	240KBE031+L
275	40.45×45.592×8°40'	40.45	45.592	8°40'	0.38300	31326DF
276	42.668×55.467×7°30'	42.668	55.467	7°30'	0.51600	LY-3018
277	43×80.23×3°20'	43	80.23	3°20'	0.60000	32244X2
278	45.72×62.23×3°2'30"	45.72	62.23	3°2'30"	0.73800	3-757
279	46×41.96×3°30'	46	41.96	3°30'	0.51500	31244
280	24.74×47.46×2°20'	24.74	47.46	2°20'	0.16300	352226X2-2RZ
281	18.557×41.965×1°48'	18.557	41.965	1°48'	0.08200	RT-641125
282	22.213×50.055×1°54'	22.213	50.055	1°54'	0.14000	RT-641134
283	10.786×13.9×4°	10.786	13.9	4°	0.00900	B3-709
284	14.261×16.1×4°	14.261	16.1	4°	0.01700	B3-710